

# ÜBERSICHTSZEICHNUNG ASSEMBLY DRAWING

# GHOST



## HYB Teru & Teru X (MY18)

2017-12-22

V01

# ÜBERSICHTSZEICHNUNG ASSEMBLY DRAWING

**GHOST**

**Hinweis:** Bei den Schrauben muss mittelfeste Gewindesicherung verwendet werden.  
**Rote Flächen müssen gefettet werden.**

**note:** use medium strength screw lock for screw threads.  
**red surfaces have to be greased.**

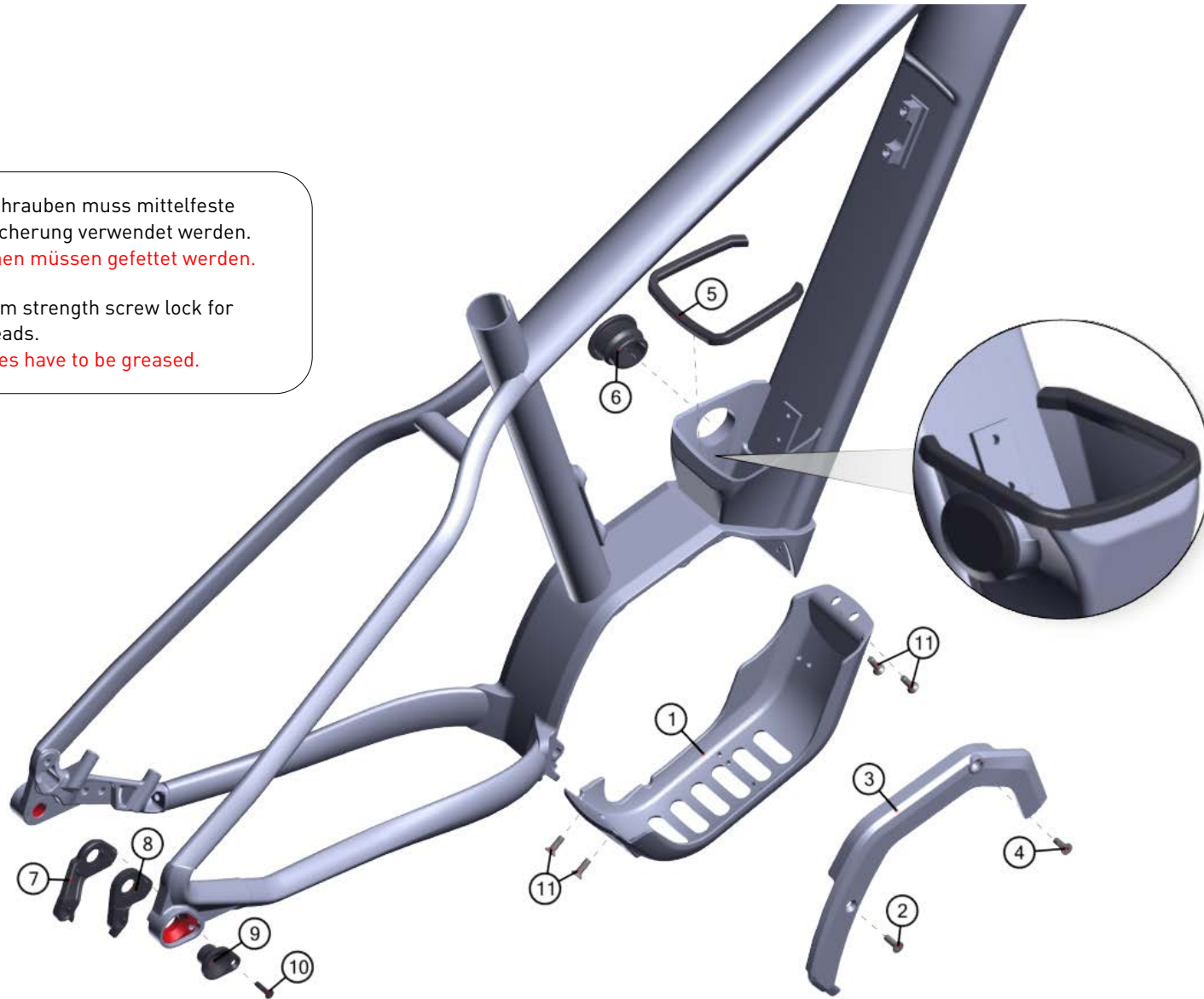

# ÜBERSICHTSZEICHNUNG

## ASSEMBLY DRAWING

**GHOST**

BOM-ID	Description	Specification	Torque	Item no.	QTY
1	Engine Cover black			FROT0033	1
2	Countersunk screw	HEX3 - M5 x 15mm	5 Nm	FRSC0012	1
3	Engine Side Cover			FROT0028	1
4	Countersunk screw	HEX3 - M5 x 20mm	5 Nm	FRSC0013	1
5	Battery Water-proof pad			FROT0012	1
6	battery rubber plug			FROT0011	1
7	Shimano Hanger (B1)			FRHG0022	1
8	SRAM Hanger (B2)			FRHG0021	1
9	Hanger Mount			FRNT0061	1
10	Flat Head Screw M4	T15 - M4 x 20mm	0,8 Nm	FRSC0061	1
11	Countersunk screw	T25 - M5 x 11mm	5 Nm	SM0920	4